

## Permit Submittal Checklist : Stucco Application

Building permits are required for stucco installation or repair on any structure. Stucco work is not classified as maintenance work. A permit for stucco work should be applied for at city hall and will be reviewed by the plan review department.

- 1) If stucco is currently on the structure and you will be tearing it off and covering the structure with new stucco, a building permit is required.
- 2) If an exterior covering (other than stucco) is currently on the structure and you will be tearing it off and covering the structure with stucco, a building permit is required.
- 3) If stucco is currently on the structure and you will be tearing it off and covering the structure with an alternate exterior covering (other than stucco) a building permit is required. (Demo, Repair, and Replace)

The permit fee for stucco application is based on the valuation of the project. The permit fee is designed to cover the cost of the plan review and the field inspections that will be performed during construction.

### Required Inspections:

1. Initial Tear Off (if applicable)
2. Lath (when weep screed, paper, and kickout flashing are applied, **before brown coat**)  
*More than one lath inspection may be required, however, if a project is done in stages and more than three inspection trips are to be done, a re-inspection fee may be charged on the fourth inspection visit.*
3. Final

### Submittal Information:

To help expedite the permit process, please ensure that all the following information is submitted at the time of your application.

#### Building Permit Application Form including:

- Date
- Site Address
- Owner
- Owner Address
- Telephone Number
- Contractor Information (INCLUDING LICENSE #)
- Description of work being performed
- Valuation of work being performed
- Signature of applicant

#### Two (2) copies of plans showing materials and application design including:

- Materials List
- Written Scope of Work

After you have all above items organized you may submit your application packet to City Hall. Please make sure all listed items are included and marked on your submittal documents, this helps to ensure effective and timely turnaround time.

## Stucco Application Final Checklist:

- Is the permit package on site and available?
- Have the General Requirements been fulfilled?

Although this list is not all-inclusive, it does contain the most common reasons for final stucco application inspection failures. If you check all of these items before you schedule your inspection, you will greatly increase your chances of easily passing the inspection.

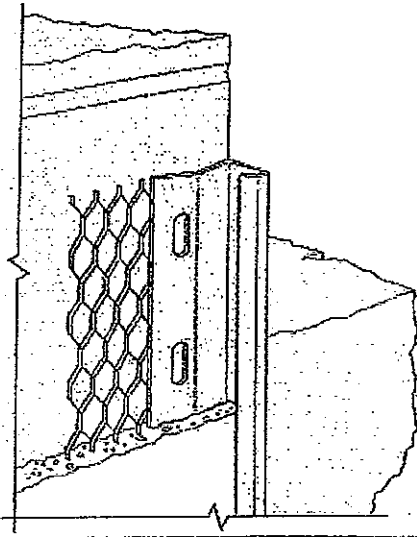

FOUNDATION WEEP SCREED INSTALLATION DETAIL

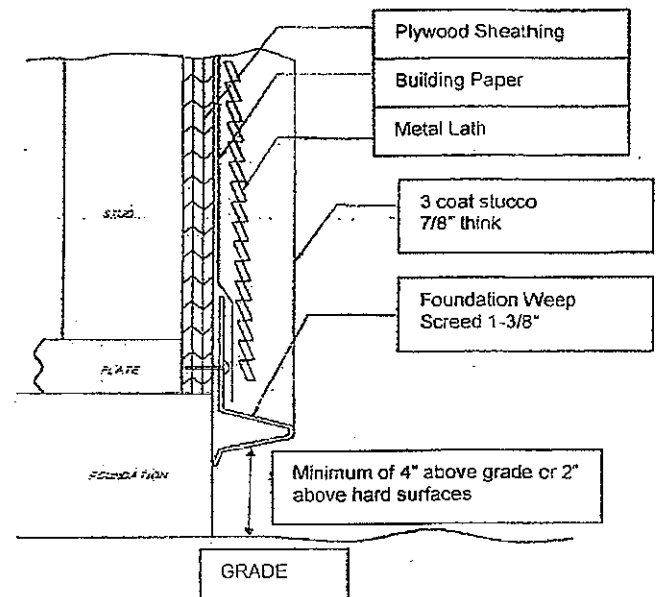

## General Stucco Application Building Requirements:

- Installation of exterior plaster shall be in compliance with ASTM C926-98a and ASTM C1063.99 and the provisions of the MN State Building Code.
- Vertical joints in paper shall be lapped at least 6 inches and horizontal joints shall be lapped at least 2 inches.
- Exterior openings shall be flashed to make them weatherproof.
- Weather resistive barriers over wood base sheathing shall include two (2) layers of grade D paper.
- A corrosion resistant weep screed with a minimum vertical attachment flange of 3 ½ inches shall be provided at or below the foundation plate line on all exterior stud walls. The screed must be placed at minimum of 4 inches above the earth or 2 inches above paved areas and shall be of a type that will allow trapped water to drain to the exterior of the building.
- Stucco must cover, but not extend below the lath and paper for slab on grade construction.
- Fasteners for metal lath must be 6 inches on center at supports.

- The building official may require additional inspections.
- Type 15 or 15# felt is not grade D paper.
- Paper must be installed on the entire wall, including within the soffits framing.
- All paper must be installed shingle fashion.
- Nailing flanges on windows shall not be accepted for flashing unless the Manufacturer's installation instructions are provided stating that the flange is acceptable as flashing.
- Exterior penetrations shall be weatherproofed (i.e., windows, deck ledgers, pipe and vent penetrations, etc.). Weatherproof by definition; that can withstand exposure to wind, rain, snow etc., without being damaged. This is a critical area that needs detailed attention before being covered by stucco.
- Kickout flashing needs to be installed at wall/roof intersections where the roofline does not extend past the wall.

**General Notes:**

1. The approved Plan shall be kept on the job site until the final inspection has been made.
2. The Inspection Record Card shall be posted until the final inspection has been made. Cards should be protected from the weather.
3. Post Address on construction site visible from the street.

*\*The State of Minnesota requires that all residential building contractors, remodelers and roofers obtain a state license unless they qualify for a specific exemption from the licensing requirements. Any person claiming an exemption must provide a copy of a Certificate of Exemption from the Department of Labor & Industry to the City before a permit can be issued.*

*\*To determine whether a particular contractor is required to be licensed or to check on the licensing status of individual contractors, please call the Minnesota Department of Labor & Industry at 651-284-5065 or toll free 1-800-342-5354 or visit their website at <http://www.doli.state.mn.us>.*

# Building Inspection Department

## Stucco application on wood frame structures

When filling out application for a building permit, which includes stucco application as part of the project, information to verify code compliance should be included with submittal documents.

Building Code requirements related to stucco include:

- **MN Rules 1309.0703 Subpart 1** - Vertical joints in paper shall be lapped at least 6 inches and horizontal joints shall be lapped at least 2 inches.
- **MN Rules 1309.0703 Subpart 9** - Exterior openings shall be flashed to make them weatherproof.
- **MN Rules 1309.0703 Subpart 3 R703.6.3** - Weather resistive barriers over wood base sheathing shall include two (2) layers of grade D paper.
- **MN Rules 1309.0703 Subpart 3 R703.6.4** - A corrosion resistant weep screed with a minimum vertical attachment flange of 3 ½ inches shall be provided at or below the foundation plate line on all exterior stud walls. The screed must be placed at minimum of 4 inches above the earth or 2 inches above paved areas and shall be of a type that will allow trapped water to drain to the exterior of the building.
- **MN Rules 1309.0703 Subpart 3 R703.6.2** - Stucco must cover, but not extend below the lath and paper for slab on grade construction.
- **MN Rules 1309.0703 Subpart 3 R703.6.1** - Fasteners for metal lath must be 6 inches on center at supports.
- **MN Rules 1300.0210 Subpart 6 paragraph K** - The building official may require additional inspections.
- Type 15 or 15# felt is not grade D paper.
- **MN Rules 1309.0703 Subpart 1 R703.2** - Paper must be installed on the entire wall, including within the soffits framing.
- All paper must be installed shingle fashion.

- Nailing flanges on windows shall not be accepted for flashing unless the Manufacturer's installation instructions are provided stating that the flange is acceptable as flashing.
- Exterior penetrations shall be weatherproofed (i.e., windows, deck ledgers, pipe and vent penetrations, etc.). Weatherproof by definition; that can withstand exposure to wind, rain, snow etc., without being damaged. This is a critical area that needs detailed attention before being covered by stucco.
- Kickout flashing needs to be installed at wall/roof intersections where the roofline does not extend past the wall.

If you should have any questions, please call the Building Official.